

ITEM NO	ENFIELD PART NO	UNIT DESCRIPTION	QTY PER CAR	REMARKS	UNIT PRICE	OUR DTC. NO. OR SUPPLIERS PART NO.	ITEM NO	ENFIELD PART NO	UNIT DESCRIPTION	QTY PER CAR	REMARKS	UNIT PRICE	OUR DTC. NO. OR SUPPLIERS PART NO.
<u>BODY FITTINGS cont'd.</u>													
107215		Catch sliding window R.H.	1		1.09	B.M.C. 24A 1194	1185	201201	Arm steering LH	1		4.11	Chrysler 2103677
107216		" " " L.H.	1		1.09	" " 1195	1890/3	" " RH	1		4.11	" " 2103678	
107217		" " " L.H.	1		1.09	" " 1196	80	Key	2		.13	" " 3200253	
107218		Gasket, window catch	1		1.09	B.M.C. " 1197	82	Nut	2		.17	" " 97572083	
107219		" " " L.H.	4		.17	" " 1198	68	Knasher	2		.06	" " 20863318	
107220		Nut, window catch	4		.28	B.M.C. " 201007	67	Rod, adjustable	2		3.50	" " 20863350	
107221		Slide, window catch	8		.06	" " 24A 1303	69	" "	2		3.50	" " 21071125	
107222		Slide, re-arranging strip R.H.	1		3.33	" " 24A 1306	71	" "	2		.69	" " 21071126	
107223		" " " L.H.	1		3.33	Enfield	74	Sleeve	2		.11	" " 92891196	
107240		Glove Box	1		7.13	" " "	75	Locknut LH	2		.98	" " 32207076	
107040		Electricity Box LH bottom	1		7.13	" " "	77	" RH	2		.28	" " 21071118	
107041		" " RR	1		5.75	" " "	78	Lockplate	1		.09	" " 21071119	
107051		" " Top	2		1.38	" " "	79	Plate - bolt link	1		22.08	" " 2107119	
107052		Anchor bracket spare wheel	1		.46	" " "	50	Steering Unit (track & pinion)	1		2.50	" " 2107136	
107050		Wing bolt - spare wheel	1			" " "	56	Recessed rack cover	1		1.20	" " "	
107053						" " "	55	Clamp, bellows	2		.23	" " "	
107054						" " "	56	End cap, rack cover	2		.43	" " "	
107055						" " "	57	Clamp, end cap	2		.31	" " "	
107056						" " "	62	" " bolt, rack	4		.69	" " 21071063	
107057						" " "	63	Cradle, rack mounting	2		.23	" " 21071333	
107058						" " "	64	Plate	2		.03	" " 32213369	
107059						" " "	201221	Nut	2		.03	" " 96617631	
107060						" " "	201222	Knasher	2		4.02	" " 2107129	
107061						" " "	201223	Universal Joint (track to column)	1		6.61	Chrysler 77080528 (FrEd)	
107062						" " "	201224		1		6.64	" " 71091662 mod(Ltd)	
107063						" " "	201225	Outer column, tube	1		6.37	" " Alexander SA109	
107064						" " "	201226	Bush, tube top	1		1.78	Alexander 500/1	
107065						" " "	201227	Steering wheel	1		.29	Chrysler 71091183	
107066						" " "	201228	Steering wheel hub	1		.29	" " 1237278	
107067						" " "	201229	Nut, steering wheel	1				" " 1237278
107068						" " "	201230	Bush, strikers, indicators	1				" " 1237278
107069						" " "	201231	Link, steering	1				" " 1237278
107070						" " "	201232	Link, steering	1				" " 1237278
107071						" " "	201233	Link, steering	1				" " 1237278
107072						" " "	201234	Link, steering	1				" " 1237278
107073						" " "	201235	Link, steering	1				" " 1237278
107074						" " "	201236	Link, steering	1				" " 1237278
107075						" " "	201237	Link, steering	1				" " 1237278
107076						" " "	201238	Link, steering	1				" " 1237278
107077						" " "	201239	Link, steering	1				" " 1237278
107078						" " "	201240	Link, steering	1				" " 1237278
107079						" " "	201241	Link, steering	1				" " 1237278
107080						" " "	201242	Link, steering	1				" " 1237278
107081						" " "	201243	Link, steering	1				" " 1237278
107082						" " "	201244	Link, steering	1				" " 1237278
107083						" " "	201245	Link, steering	1				" " 1237278
107084						" " "	201246	Link, steering	1				" " 1237278
107085						" " "	201247	Link, steering	1				" " 1237278
107086						" " "	201248	Link, steering	1				" " 1237278
107087						" " "	201249	Link, steering	1				" " 1237278
107088						" " "	201250	Link, steering	1				" " 1237278
107089						" " "	201251	Link, steering	1				" " 1237278
107090						" " "	201252	Link, steering	1				" " 1237278
107091						" " "	201253	Link, steering	1				" " 1237278
107092						" " "	201254	Link, steering	1				" " 1237278
107093						" " "	201255	Link, steering	1				" " 1237278
107094						" " "	201256	Link, steering	1				" " 1237278
107095						" " "	201257	Link, steering	1				" " 1237278
107096						" " "	201258	Link, steering	1				" " 1237278
107097						" " "	201259	Link, steering	1				" " 1237278
107098						" " "	201260	Link, steering	1				" " 1237278
107099						" " "	201261	Link, steering	1				" " 1237278
107100						" " "	201262	Link, steering	1				" " 1237278
107101						" " "	201263	Link, steering	1				" " 1237278
107102						" " "	201264	Link, steering	1				" " 1237278
107103						" " "	201265	Link, steering	1				" " 1237278
107104						" " "	201266	Link, steering	1				" " 1237278
107105						" " "	201267	Link, steering	1				" " 1237278
107106						" " "	201268	Link, steering	1				" " 1237278
107107						" " "	201269	Link, steering	1				" " 1237278
107108						" " "	201270	Link, steering	1				" " 1237278
107109						" " "	201271	Link, steering	1				" " 1237278
107110						" " "	201272	Link, steering	1				" " 1237278
107111						" " "	201273	Link, steering	1				" " 1237278
107112						" " "	201274	Link, steering	1				" " 1237278
107113						" " "	201275	Link, steering	1				" " 1237278
107114						" " "	201276	Link, steering	1				" " 1237278
107115						" " "	201277	Link, steering	1				" " 1237278
107116						" " "	201278	Link, steering	1				" " 1237278
107117						" " "	201279	Link, steering	1				" " 1237278
107118						" " "	201280	Link, steering	1				" " 1237278
107119						" " "	201281	Link, steering	1				" " 1237278
107120						" " "	201282	Link, steering	1				" " 1237278
107121						" " "	201283	Link, steering	1				" " 1237278
107122						" " "	201284	Link, steering	1				" " 1237278
107123						" " "	201285	Link, steering	1				" " 1237278
107124						" " "	201286	Link, steering	1				" " 1237278
107125						" " "	201287	Link, steering	1				" " 1237278
107126						" " "	201288	Link, steering	1				" " 1237278
107127						" " "	201289	Link, steering	1				" " 1237278
107128						" " "	201290	Link, steering	1				" " 1237278
107129						" " "	201291	Link, steering	1				" " 1237278
107130						" " "	201292	Link, steering	1				" " 1237278
107131						" " "	201293	Link, steering	1				" " 1237278
107132						" " "	201294	Link, steering	1				" " 1237278
107133						" " "	201295	Link, steering	1				" " 1237278
107134						" " "	201296	Link, steering	1				" " 1237278
107135						" " "	201297	Link, steering	1				" " 1237278
107136						" " "	201298	Link, steering	1				" " 1237278
107137						" " "	201299	Link, steering	1				" " 1237278
107138						" " "	201300	Link, steering	1				" " 1237278
107139						" " "	201301	Link, steering	1				" " 1237278
107140						" " "	201302	Link, steering	1				" " 1237278
107141						" " "	201303	Link, steering	1				" " 1237278
107142						" " "	201304	Link, steering	1				" " 1237278
107143						" " "	201305	Link, steering	1				" " 1237278
107144						" " "	201306	Link, steering	1				" " 1237278
107145						" " "	201307	Link, steering	1				" " 1237278
107146						" " "	201308	Link, steering	1				" " 1237278
107147						" " "	201309	Link, steering	1				" " 1237278
107148					</								

ITEM NO	ENFIELD PART NO	UNIT DESCRIPTION	QTY PER CAR	REMARKS	UNIT PRICE	OUR DRG. NO. OR SUPPLIERS PART NO.
2056/2	10721	Ignition switch	1		10.00	Chrysler 71267137
2056/2	201233	Cowl upper	1		2.35	Chrysler 7103666
36	201234	" lower	1		2.18	" 7103665
37	201235	Insert, cowl	4		-11	" 9213122
38	201236	Clamp strap	1		-17	" 7103663
39	201237	Screw, cowl	2		-.09	" 39313071
	201238	" "	2		-.86	" 39313071
	201239	Kniff	1		15.52	Chrysler 77050206
	201240	Steering column, inner, kit	1			
	201241	Clamp, steering column upper	1		.28	Chrysler 77050206 32mm
STEERING CONT'D						
MARCH 31st, 1975.						
ITEM NO	ENFIELD PART NO.	UNIT DESCRIPTION	QTY PER CAR	REMARKS	UNIT PRICE	OUR DRG. NO. OR SUPPLIERS PART NO.
BODY FITTINGS						
107017	107018	Front battery clamp	1		3.73	Assy. 7
107021	107022	Rear battery clamp	1		3.73	" 8
107024	107025	Door hinge mounting LH	1		3.27	" 30
107013	107014	" RH	1		3.27	" "
107081	107082	Battery clamp tie bar front	2		1.09	" 13
107082	107083	Headlamp bracket outer	2		1.52	Pattern
107085	107086	" inner	2		1.52	" "
107095	107096	Hinge door LH LH	4		3.27	E8000-N-1
107019	107020	" RH	1		1.15	" 5
107020	107021	Mounting bracket - wiper	1		1.15	" 6
107021	107022	Halcer - Fuse box	1		1.09	" 19
107023	107024	Mounting bracket - horn	1		1.32	" 20
107102	107103	Bonnet release bracket	1		1.03	" 21
107102	107103	Spacer - Front bumper	1		-.92	" 25
107102	107103	Shocking Plate Door latch	2		-.51	" 101
107102	107103	Bolt special - front bumper attach.	2		.69	" 26
107102	107103	Towing eye	2		.51	" 103
107034	107035	Bonnet hinge arm LH	1		1.76	E8000-S-34
107035	107036	Bonnet hinge arm RH	1		1.76	" 34
107036	107037	Bonnet hinge pivot LH	1		1.09	" 34
107037	107038	" RH	1		1.09	" 34
107046	107047	Door handle bracket	2		1.55	" 44
107047	107048	Door seal	2		2.01	Comfie
107202	107203	Catch, bonnet	1		.86	Minot Bredren 3/22780
107203	107204	Safety catch, bonnet	1		.86	Ford 120E 16892E
107204	107205	Cable bonnet release	1		.92	Bellex
107205	107206	Seal, "up" bonnet and boot	2		2.47	Comfie
107206	107207	Handle, door, ext. LH	1		1.72	Chrysler 72273467
107207	107208	" RH	1		2.47	72273467
107208	107209	Lock, boot	1		.74	Minot Bredren 3/22780
107209	107210	Door handle, remote, int. LH	1		.74	" "
107210	107211	Lock, door LH	1		1.72	" "
107211	107212	" RH	1		1.72	" "
107212	107213	Striker, door latch	2		.78	" "
107213	107214	Cover, plate	2		.17	" "
107214	107215	Bracket, int. door handle	2		.13	" "
107215	107216	Pull door	2		.86	" "
MARCH 31st, 1975.						
MNC ADA 587A						

PART NO. SYSTEM

Part numbers consist of six numbers.

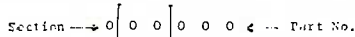

Subsection
200 series B-Out Items

SECTION:

- 1. Body
- 2. Mechanics
- 3. Electric
- 4. Ancillaries
- 5. Accessories

SUBSECTIONS:

- | | |
|--------------------|----------------------------|
| 1. <u>Body</u> | 2. <u>Mechanics</u> |
| 01 Chassis | 01 Steering |
| 02 Floor | 02 Suspension |
| 03 Skeleton | 03 Rear Axle |
| 04 Panels | 04 Transmission |
| 05 Glass | 05 Brakes |
| 06 Trim and Seats | 06 Controls (accelerator) |
| 07 Fittings | |
| 3. <u>Electric</u> | 4. <u>Ancillaries</u> |
| 01 Motor | 01 Seat belts |
| 02 Instruments | 02 Instruments |
| 03 Controls | 03 Wiper parts |
| 04 Batteries | 04 General items |
| 05 Charger | |
| 06 Equipment | 5. <u>Tools and Extras</u> |
| 07 Lights | 01 Extras |
| 08 Wiring | 02 Tools |

MARCH 31st, 1975.

ITEM NO	ENTERED PART NO	UNIT DESCRIPTION	QTY PER CAR	REMARKS	UNIT PRICE	OUR DRG. NO. OR SUPPLIER'S PART NO.
		<u>ELECTRICS - Equipment</u>				
	306201	Switch, headlamp	1		1.72	Lucas 35992
	306202	" windscreen wiper	1		1.72	" 39306.
	306203	" heater	1		1.72	" 39100
	306204	" demist	1		1.72	" 39100
	306205	" washer	1		1.72	" 35011
	306206	Switch, emergency cutout	1		1.86	" 31286
	306207	Switch, hazard warning	1	Kt complete	4.02	" 54006901
	306208	Switch, reverse	1	not required on	1.72	" 31696
	306209	Switch, indicator, horn, headlamp	1	lever reverse	7.18	" 39150
	306211	Microswitch handbrake	1		.80	Ilcon VA 314
	306212	Switch, brake light	1		1.09	Lucas 34933
	306213	Indicator light, amber	1		.40	"
	306214	Indicator light, green	1		.40	"
	306215	" " red	1		.40	"
	306216	" " blue	2		.40	"
	306220	Flasher unit	1		1.09	Lucas 35020
	306221	Flasher unit	1		.19	5438/268
	306222	CHP, Flasher unit	1		2.81	" 781/37416
	306223	Fuse box	2		3.96	"
	306224	Horn	1		.04	Commercial
	306225	Fuse, auxiliary	8	35 amp	5.06	E.F. GSA 600
	306227	Fuse, traction	4		2.01	"
		Relay, voltmeter isolation	1			"
		Power switch (see steering No. 201222)				"
		MARCH 31st, 1975.				"

COMMERCIAL AVAILABLE COMPONENTS AS FOLLOWS:

- Millman Inc: steering rack and column, steering rods and complete stub axles, also drive shaft.
 - Morris Mini: front brakes complete.
 - Reliant: rear brakes and handbrakeassy.
 - Donat Hays: rear axle.
 - Lockheed: dual brake system.
- Chassis, wheelbases, body, etc of Enfield design and manufacture.

00

00

ITEM NO	FIELD PART NO.	UNIT DESCRIPTION	QTY PER CAR	REMARKS	UNIT PRICE	OUR DRG. NO. OR SUPPLIERS PART NO.
		<u>CHARGER - Electric cont'd</u>				
305636		Socket Strip P.C.B.	2	22 pin	1.22	
305637		Plug - 8 way	1		.22	
305638		Plug - 4 way	1		.90	
305639		Plug - 3 way	1		.28	
305640		Socket - 6 way	1		.31	
305650		Fuse	1	13 amp x 1 1/4"	.11	
305651		Fuse	1	2 amp x 20 mm	.06	
305652		Fuse	1	160 M.A. x 20 mm	.06	
305653		Fuse	2	800 M.A. x 20 mm	.06	
305654		Fuse	2	630 M.A. x 20 mm	.06	
305655		Fuse	2	200 M.A. x 20 mm	.06	
305660		Loom - 8 way	1	Control/Rectifier	5.06	
305661		Loom - 6 way	1	Control/Rectifier	4.02	
305662		Loom - 4 way	1	Transformer/Control	3.22	
		MARCH 31st, 1975.				

LUCAS

12 VOLT HAZARD WARNING SYSTEM
(PART No. 54006501)
INSTALLATION AND WIRING INSTRUCTIONS

The Lucas Hazard Warning Device consists of a push-pull multi-contact switch and a Heavy Duty type flasher unit incorporated in a mounting bracket. The device is pre-wired for connecting into the existing direction indicator circuit.

MOUNTING

Choose a convenient position on the lower edge of the fascia panel for mounting the Hazard Device ensuring the warning light in the knob is clearly visible to driver.

Drill two holes $\frac{1}{8}$ " (0.125") (3.5 mm) diameter at 1.5" (38 mm) centres and fix the device in position.

WIRING

NOTE: All extension leads between the device and the vehicle wiring must be 14/0.010" (14/0.25 mm) cable minimum.

Connect cables from the Hazard Warning Device as follows:-

1. PURPLE - battery supply point such as ammeter, A2 feed etc. not via Ignition switch.
2. GREEN/WHITE - to green/white cable of existing R.H. flasher circuit.
3. GREEN/RED - to green/red cable of existing L.H. flasher circuit.
4. GREEN/BROWN - disconnect feed cable (normally green) from feed or 'B' terminal of vehicle flasher unit and connect either green/brown cable to free end of disconnected cable.
5. GREEN/BROWN - to now vacant flasher unit feed or 'B' terminal.
6. BLACK - to a convenient good earth point.

DIRECTION INDICATOR SIGNALS

Direction Indicators

The correct operation of direction signals requires that the flasher filament in the lamp bulbs (depending on the position of the switch) flash intermittently whether or not the headlamps, parking lamps, tail lamps or stop lamps are "on".

A correctly operating direction signal will be indicated by a regular intermittent flashing of the green pilot lamp located on fascia panel. If, when the direction indicator is switched on, the warning (or pilot) lamp does not flash in the usual manner but remains unlit, first check that this is not due to filament failure in either the front or rear lamp on that side. This can be checked by turning the switch to the opposite side—if the pilot lamp now flashes, the circuit is in order and bulb replacement is indicated. On the other hand, if the pilot lamp still does not flash, inspect the indicator lamps. If these are working normally, failure of the pilot lamp bulb is indicated. If, however, the indicator lamps are not functioning, it will be necessary to proceed to check the wiring and flasher unit.

The efficiency of the flasher unit may be readily checked by fitting a known substitute.

The inoperative flasher lamp bulbs should be checked for a burned-out filament. Where it is found that neither lamp has a burned-out filament the wiring between the defective lamp and indicator switch must be checked.

The flasher unit is located inside the car and is attached to the underside of the fascia. No servicing of the flasher is required, and where this unit breaks down in service it must be renewed.

Operation of Flasher Unit (See Fig. 29)

This unit depends for its operation on the linear expansion of a piece of wire which becomes heated as current flows through it.

The actuating wire controls the movement of a spring-loaded main armature hinged to a central steel core and carrying the moving member of a pair of contacts ("A", Fig. 29).

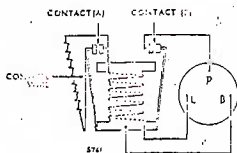

Fig. 29. Internal connections of flasher unit

As current flows from terminal "B" to terminal "L" and the lamps via the actuating wire and an additional ballast resistor, the wire heats up and expands.

This allows the main armature to move inwards towards the core, closing contacts "A" and short-circuiting the ballast resistor and actuating wire, so that full voltage is applied to the indicator lamps, which now illuminate.

The increased electromagnetic attraction due to full lamp current now flowing through the coil wound on the core, holds the armature firmly so that the contacts are fully closed. It also attracts the pilot or secondary armature to the core, closing contacts "B" and illuminating the pilot lamp.

Since the actuating wire is by-passed when the main contacts are closed, the wire cools and contracts. Eventually, the tension of the contracting wire is sufficient to overcome the electromagnetic attraction and the hinge spring force, resulting in contacts "A" being separated, the lamps being extinguished, and the pilot armature being released.

This sequence of operations continues until the indicator switch is returned to the OFF position.

The pilot lamp on the fascia panel will not flash unless sufficient current to light the filaments in front flasher lamp and rear flasher lamp is passing through the windings of the electro-magnet to close contacts (B). The flashing pilot lamp, therefore, gives the driver a clear indication that the direction signals are working correctly. It will be noted that in order to maintain the desired rate of flashing (British Ministry of Transport regulations, 60-120 per minute) the filaments of the front and rear lamps are "pre-heated" via the resistance wire during "out" period of the flash.

ITEM NO.	ENFIELD PART NO	UNIT DESCRIPTION	QTY PER CAR	REMARKS	UNIT PRICE	OUR PRG. NO. OR SUPPLIERS PART NO.
		ELECTRICS - WIRING				
	308001	Loom, dash panel	1		16.44	E.8000-E-5
	308002	Loom, control circuit	1		10.46	" " 6
	308003	Loom, rear auxiliaries	1		9.66	" " 5
	308201	Socket, 11 way connector	7		.36	Ampliversal 15126/1
	308202	Plug, " "	7		.36	15125/1
	308020 to 308047	Bus bar, solenoid link)	38		2.24	E8000-F-21 & 22
	308050	Cable battery link	8		3.22	E8000-F-1 (cable-traction terminal - Ampliversal 3692Z)
	308060 to 308061	Cable traction, battery to fuse	4		2.87	(Cable - traction
	308062	" " Link B4-	1		10.98	(terminal - Ampliversal 3692Z
	308063	" " " B1-	1		10.98	E8000-F-21 & 22
	308064	" " " " "	1		12.53	
	308065	" " " " "	1		12.53	
	308066	" " " " "	1		12.99	
	308067	" " " " "	1		12.99	
	308068	" " " " "	1		12.53	
	308069	" " " " "	1		12.53	
	308070	" " " " "	1		12.53	
	308080	Cable, charger, B4-	1		4.94	Cable charge
	308081	" " " B1-	1		5.63	
	308210	Gland, traction cable	10	larger	.80	
	308211	" " " "	6	smaller	.80	

MARCH 31st, 1975.

DIRECTION INDICATOR SIGNALS

Direction Indicators

The correct operation of direction signals requires that the flasher filament in the lamp bulbs (depending on the position of the switch) flash intermittently whether or not the headlights, parking lamps, tail lamps or stop lamps are "on".

A correctly operating direction signal will be indicated by a regular intermittent flashing of the green pilot lamp located on fascia panel. If, when the direction indicator is switched on, the warning (or pilot) lamp does not flash in the usual manner but remains unit, first check that this is not due to filament failure in either the front or rear lamp on this side. This can be checked by turning the switch to the opposite side—if the pilot lamp now flashes, the circuit is in order and bulb replacement is indicated. On the other hand, if the pilot lamp still does not flash, inspect the indicator lamps. If these are working normally, failure of the pilot lamp bulb is indicated. If, however, the indicator lamps are not functioning, it will be necessary to proceed to check the wiring and flasher unit.

The efficiency of the flasher unit may be readily checked by fitting a known substitute.

The inoperative flasher lamp bulbs should be checked for a burned-out filament. Where it is found that neither lamp has a burned-out filament the wiring between the defective lamp and indicator switch must be checked.

The flasher unit is located inside the car and is attached to the underside of the fascia. No servicing of the flasher is required, and where this unit breaks down in service it must be renewed.

Operation of Flasher Unit (See Fig. 29)

This unit depends for its operation on the linear expansion of a piece of wire which becomes heated as current flows through it.

The actuating wire controls the movement of a spring-loaded main armature hinged to a central steel core and carrying the moving member of a pair of contacts ("A", Fig. 29).

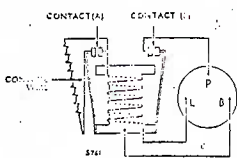

Fig. 29. Internal connections of flasher unit

As current flows from terminal "B" to terminal "L" and the lamps via the actuating wire and an additional ballast resistor, the wire heats up and expands.

This allows the main armature to move inwards towards the core, closing contacts "A" and short-circuiting the ballast resistor and actuating wire, so that full voltage is applied to the indicator lamps, which now illuminate.

The increased electromagnetic attraction due to full lamp current now flowing through the coil wound on the core, holds the armature firmly so that the contacts are fully closed. It also attracts the pilot or secondary armature to the core, closing contacts "B" and illuminating the pilot lamp.

Since the actuating wire is by-passed when the main contacts are closed, the wire cools and contracts. Eventually, the tension of the contracting wire is sufficient to overcome the electromagnetic attraction and the hinge spring force, resulting in contacts "A" being separated, the lamps being extinguished, and the pilot armature being released.

This sequence of operations continues until the indicator switch is returned to the OFF position.

The pilot lamp on the fascia panel will not flash unless sufficient current to light the filaments in front flasher lamp and rear flasher lamp is passing through the windings of the electro-magnet to close contacts (B). The flashing pilot lamp, therefore, gives the driver a clear indication that the direction signals are working correctly. It will be noted that in order to maintain the desirable rate of flashing (British Ministry of Transport regulations, 60-120 per minute) the filaments of the front and rear lamps are "pre-heated" via the resistance wire during "out" period of the flash.

ITEM NO.	ENFIELD PART NO	UNIT DESCRIPTION	QTY PER CAR	REMARKS	UNIT PRICE	OUR PRG. NO. OR SUPPLIERS PART NO.
		ELECTRICS - WHITING				
	308001	Loom, dash panel	1		16.44	E.8000-E-5
	308002	Loom, control circuit	1		10.46	" " 6
	308003	Loom, rear auxiliaries	1		9.66	" " 5
	308201	Socket, 11 way connector	7		.36	Ampliversal 15126/1
	308202	Pilot,	7		.36	15125/1
	308020 to 308047	Bus bar, solenoid (link)	38		2.24	E8000-E-21 & 22
	308030	Cable battery link	8		3.22	E8000-F-1 (cable-traction terminal - Ampliversal 36922)
	308060 to 308061	Cable traction, battery to fuse	4		2.87	(Cable - traction terminal - Ampliversal 36922)
	308062	" " Link B4	1		10.98	
	308063	" " " B1-	1		10.98	E8000-E-21 & 22
	308064	" " " " " " "	1		12.53	
	308065	" " " " " " "	1		12.99	
	308066	" " " " " " "	1		12.53	
	308067	" " " " " " "	1		12.99	
	308068	" " " " " " "	1		12.53	
	308069	" " " " " " "	1		12.53	
	308070	" " " " " " "	1		12.53	
	308080	" " " " " " "	1		12.53	
	308081	Cable, charger, B4	1		4.94	Cable charge
	308210	" " " B1-	1		5.63	
	308211	Gland, traction cable	10	larger	.80	
		" " " "	6	smaller	.80	
		MARCH 31st, 1975.				

ITEM NO	ENGINE FIELD PART NO	UNIT DESCRIPTION	QTY PER CAR	REMARKS	UNIT PRICE	OUR PRG. NO. OR SUPPLIERS PART NO.
		ANCILLARY EQUIPMENT				
401201		Seat belt assy	2		9.89	Britax DSP 200
404201		Mirror, interior	1		.69	Chrysler 7080371
406202		Stem, mirror, interior	1		3.16	" 7080372
406203		Light, interior	1		.92	" 7103435
402202		Speedometer (See Instruments)	1		2.81	" DFL157/48R3
402203		Drive, speedometer	1		1.32	Smiths
403101		Trip adjuster	2	17"	2.38	Lucas 54705234,
403102		Wiper arm	2		1.89	" 54702612
403103		" blade	2		3.39	" 72866A
403104		Wheel box, wiper	2		3.39	" 547047/82
403105		Wheel box, kit	2		11.51	" 75664
403106		Noct, wiper	1		2.41	" 54702583
403207		Gear, wiper motor	1		1.38	" 547047/82
		Rack, wiper drive	1			
403308		Tube, track cover L.H.	1		1.89	Lucas 745028
403209		" " centre	1		1.89	
403210		Ferrule, wiper motor	1		.40	Lucas 54704623
403212		Strap	1		.69	" 54701783
403211		Pad, wiper motor mounting	1		.40	" 54701831
403213		Socket, wiper motor	1		.23	" 54939680
403214		Connector "	1		.23	"
403215		Windscreen washer assy.	1		2.87	Tudor
403216		Battery tray - front	1		6.90	Entleld/Right Plastics
403217		Battery tray - rear	1		6.90	Entleld/Right Plastics
		MANORON 31st, 1975.				

Page 30

Section N (Electrical Equipment)

FRONT SIDE-AND-FLASHER LAMPS

Lucas L717 (Fig. 26)

The front side-and-flasher lamps are not interchangeable, one being for left-hand fitting, and the other for right-hand fitting. All four bulbs are the single filament type.

Each lamp has a die-cast metal body on which is mounted a two-piece plastic lens. Compartments are provided in the lamp body for the side and flasher lights, that for the side light containing the lower wattage bulb.

The lens projects to provide effective sideways illumination, the lens piece for the flasher light being coloured amber for most territories, and that for the side light being clear.

Bulb renewal

Remove the two screws securing the lens to the lamp body and withdraw the lens. The bulbs are now accessible and can be removed by a push and anti-clockwise movement. Fit a new bulb or bulbs, ensuring that both are correctly tensioned in their holders.

Refit the two-piece lens and secure with the two fixing screws, correctly locating the foam rubber seal and avoiding overtightening the fixing screws.

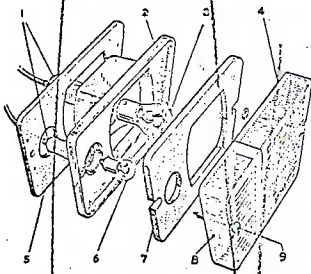

Fig. 26. L717 Side-and-flasher lamp (left hand)

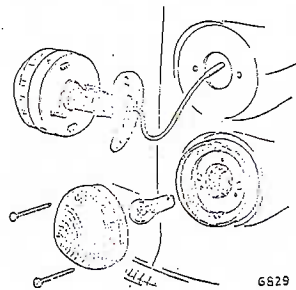

Fig. 27. Exploded view of stop/tail and rear flasher lamps

STOP/TAI AND REAR FLASHER LAMPS

(See Fig. 27)

To renew a defective bulb, remove the two screws which retain the amber lens or the red lens.

To detach the lamp unit, remove two nuts at the rear of the lamp (collect the plain and spring washers), disconnect the cable(s) at the snap connector(s) and withdraw the lamp unit.

REAR NUMBER PLATE LAMP (See Fig. 25)

To gain access to the bulb for renewal, remove the two screws that secure the glass dome and lift off the sponge rubber seat. After the bulb has been renewed refit the glass dome onto its sponge rubber seat and secure the whole with the two screws.

To detach the lamp body, remove the two nuts and bolts which secure it to the platform mounted on the engine hood; disconnect the red cable at the single snap connector and feed the cable through the grommet lined hole in the structure of the engine hood.



Fig. 25. Rear number plate lamp

ELECTRICAL EQUIPMENT

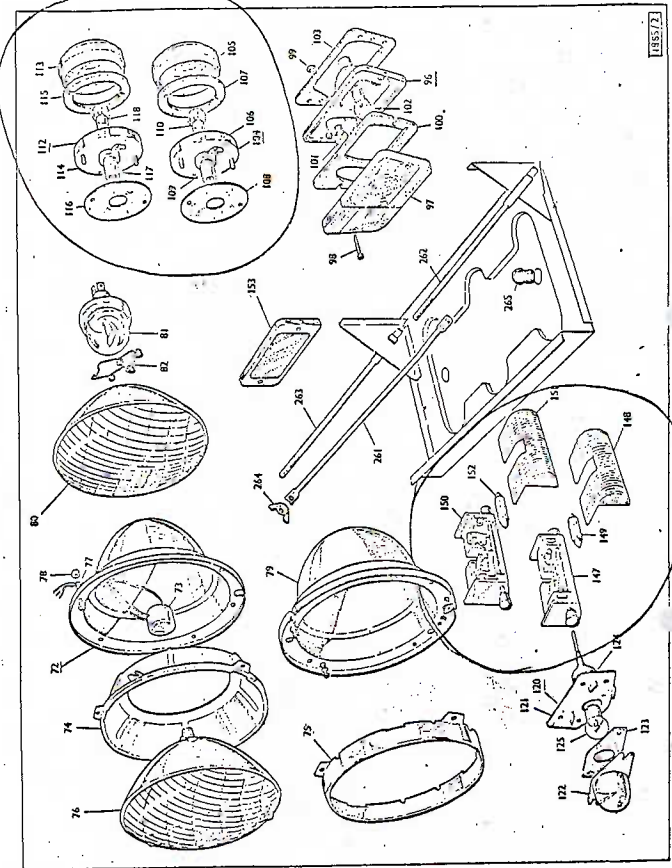
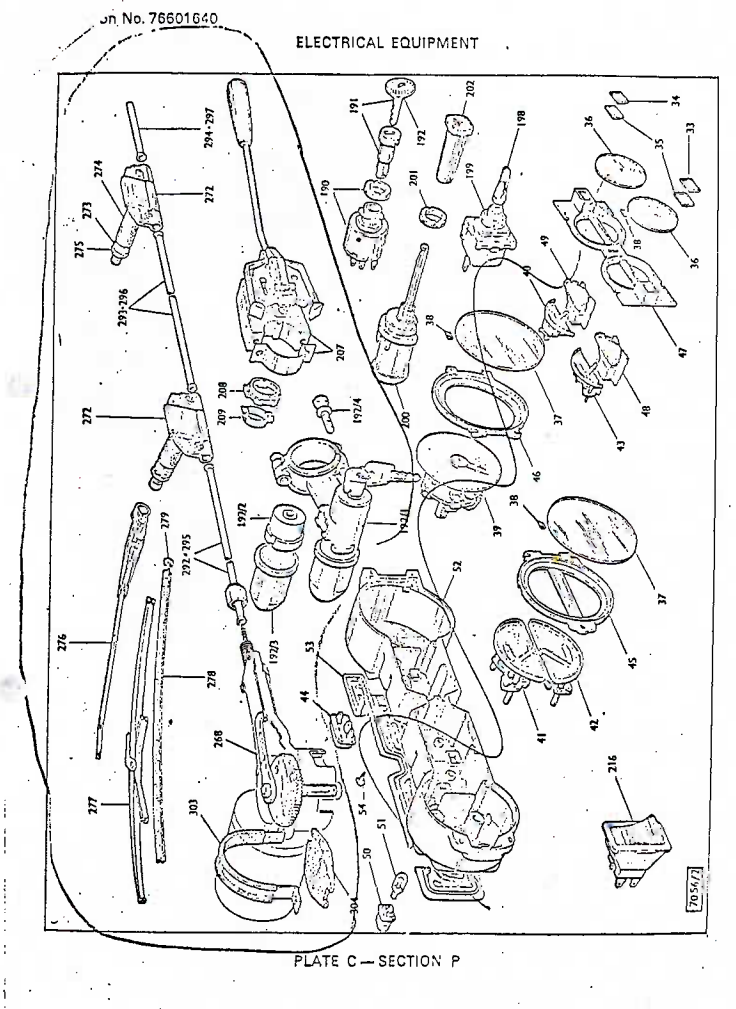

PLATE D - SECTION P

ITEM NO	ENFIELD PART NO	UNIT DESCRIPTIC.	QTY PER CAN	REMARKS	UNIT PRICE	OUR DRG. NO. OR SUPPLIERS PART NO.
		<u>CONTROLS</u>				
	206022	Accelerator Box Body	1		10.06	E8000-N-22
	206116	Lever (accelerator link)	1		1.43	" " I16
	206117	Sleeve (accelerator cam)	1		.97	" " I17
	206118	Retaining (accelerator cam)	2		.97	" " I18
	206119	Cam (accelerator)	1		6.21	" " I19
	206120	Ring (cam retaining)	1		.97	" " I20
	206121	Accelerator Pedal Lever	1		2.35	BMC R86, J46
	206122	Pedal rubber	1		.57	BMC GFR, 105
	206123	Microswitch	4		.80	14com V3.534
MARCH 31st, 1975.						

ITEM NO	EXTENDED PART NO.	UNIT DESCRIPTION	QTY PER CAB	REMARKS	UNIT PRICE	OUR DRG. NO. OR SUPPLIERS PART NO.
		<u>ELECTRICS - Lights</u>				
307201		Headlamp R.H.D.	2	Sealed beam	10.92	Lucas 60351
307201		" L.H.D.	2	"	10.92	" 60092
307203		Direction indicator lamp, front.	2		2.81	" 54R02
307204		Direction indicator lamp, rear.	2		2.87	" 52731
307205		Stop and tail lamp	2		2.99	" 56137
307206		Reflector	2		2.01	" 57098
307207		No. plate lamp	2		1.66	" 54556
		31st March, 1975.				



LIGHT NO	PART NO	UNIT DESCRIPTIVE	QTY	REMARKS	UNIT PRICE	SUPPLIER'S PART NO.
		<u>DRIVES cont'd</u>				
		<u>Handbrake</u>				
	205067	Mounting bracket, handbrake lever	1		8.05	ER000-C-67
7012/2	205901	Handbrake lever	1		2.99	Chrysler 7103154
15/9	205902	Handbrake cable Assy	1		5.06	Reliant 20100
" /10	205903	Pulley, compensator	1		1.03	" 204085
11	205904	Clevis pulley	1		.11	" 200271
14	205905	Clevis pin and split pin	1		.11	" 546848
15	205906	Clevis pin, cable to brake	1		.09	" 511328
23	205907	Pin, lever pivot	2		.98	" 548188
	205008	Pin, lever pivot	1		.60	ER000-M-8
	205009	Adjuster plate, handbrake rod	1		.57	" 9
	205072	Rod handbrake gm thread x 22516	1		.80	" 23
	205908	Gaiter, handbrake lever	3		.40	Chrysler 7103154

MARCH 31st, 1975.

Measure light running current and speed:
 Disconnect the cable rack at the gearbox; to do this, first mark the position of the domed limit switch cover with relation to the gearbox cover. Withdraw the four self-tapping screws which secure the gearbox cover and lift off the cover. Take off the spring clip which secures the connecting rod on the crankpin, also removing the rotating limit switch; the connecting rod can now be lifted off.

Connect a first grade moving-coil ammeter in the motor supply cable and measure the light running current. Also observe the operating speed by counting the speed of rotation of the final gear. The light running current should not exceed 3-4 amperes, and the gear speed should be between 44 to 50 r.p.m. (after running for 60 seconds). If the motor does not run, or the light running current and speed are not as stated, an internal fault in the motor is indicated; a new motor must be fitted, or the existing motor removed for further examination.

Check cable rack, tubing and wheelboxes:
 If the light running current and speed are correct, then the cause of the trouble most probably lies in the cable rack transmission.

The maximum permissible force required to move the cable rack in its protective tubing, should be not more than 6 lb. (2.7 Kg.). This can be checked while the cable rack is disconnected from the gearbox. First take off the arms and blades; then hook a spring balance into the hole in the crosshead into which the pin on the connecting rod is normally fitted. Withdraw the rack with the balance, noting the force required.

Binding of the rack can be attributed to kinked or flattened tubing, or to faulty installation. Any badly kinked or flattened tubing must be renewed. Any curves of less than 9 inches (23 cm.) radius must be reformed. The cable rack must be well lubricated with grease.

When the cable rack is removed, check the wheelboxes for looseness, misalignment or binding of the spindle, and rectify or renew as found necessary.

Reconnecting cable rack:
 This is a reversal of the procedure outlined above, taking care to refit the domed limit switch cover in its original position. Ensure that the hexagon nut which secures the tubing to the gearbox is not cross-threaded.

To remove and refit wiper motor
 The wiper motor is mounted on the left hand front wheel arch. Disconnect the battery. Remove the fibre-board

cover protecting the wiper motor. Withdraw the three Lucas leads from the motor terminals. Disconnect the cable rack transmission as previously described. Remove the three set screws which secure the motor mounting plate. The motor can now be lifted from its position. To refit, reverse the procedure for removal and refit the displaced earth cables on the mounting plate.

Limit switch adjustment
 The correct working of the limit switch is obtained when the setting pin on top of the domed cover is in line with the central groove in the gearbox cover. Parking of the blades in the opposite extreme position can be effected by slackening the four gearbox cover screws and rotating the limit switch cover through 180°.

ITEM NO.	ENFIELD PART NO.	UNIT DESCRIPTION	QTY PER CAR	REMARKS	UNIT PRICE	OUR DRG. NO. OR SUPPLIERS PART NO.	ITEM NO	ENFIELD PART NO	UNIT DESCRIPTION	QTY PER CAR	REMARKS	UNIT PRICE	OUR DRG. NO. OR SUPPLIERS PART NO.
		<u>STABILIZER</u>											
103001		Front door post L.H.	1		26.17	E8000-5-1							
103002		Rear door post L.H.	1		18.17	" " 2							
103003		Rear window pillar L.H.	1		10.12	" " 4							
103004		Rear window pillar L.H.	1		10.12	" " 5							
103005		Roof bow forward	1		8.22	" " 6							
103006		" " centre	1		8.22	" " 7							
103007		Roof support rear	1		6.27	" " 8							
103008		" " rear	1		22.31	" " 9							
103009		Still L.H.	1		15.15	" " 10							
103010		Cam L.H.	1		14.83	" " 11							
103011		Cam L.H.	1		14.83	" " 12							
103012		Header bar	1		21.27	" " 13							
103013		Scuttle rail	1		23.00	" " 14							
103014		Scuttle rail L.H.	1		8.10	" " 15							
103015		Scuttle rail R.H.	1		8.10	" " 16							
103016		Side window rail L.H.	1		8.10	" " 17							
103017		Side window rail R.H.	1		8.10	" " 18							
103018		Infill web-rear arch L.H.	1		7.95	" " 19							
103019		Infill web-rear arch L.H.	1		7.95	" " 20							
103020		Front slide web (arch to ft.post) L.H.	1		8.05	" " 21							
103021		Rear slide web (arch to rear post) L.H.	1		7.99	" " 22							
103022		" " " " " " " " R.H.	1		10.46	" " 23							
103023		Front beam	1		6.32	" " 24							
103024		Side former (ft. of ft. batt. bay) L.H.	1		11.15	" " 25							
103025		Side former " " " " " " R.H.	1		22.77	" " 26							
103026		Bonnet lock mounting bracket	1		4.54	" " 27							
103027		Bonnet frame	1		4.54	" " 28							
103028		Floor extension fwd. (ft. batt. bay) L.H.	1		4.56	" " 29							
103029		Floor extension fwd. (ft. batt. bay) L.H.	1		4.42	" " 30							
103030		Top slide former " " " " " " R.H.	1		1.50	" " 31							
103031		Rear shelf support angle	1		3.90	" " 32							
103032		Rear shelf outer L.H.	1		4.94	" " 33							
103033		Rear shelf outer L.H.	1		4.94	" " 34							
103034		Rear shelf panel	1		12.47	" " 35							
103035		Dash panel	1			" " 36							
103036		31st March, 1975.				" " 37							
		<u>BRAKES</u>											
		Rear Brakes											
		Rearbrake assy LH	1		9.54	Reliant 20201							
		" " RH	1		9.54	" " 20202							
		Backplate LH	1		7.47	" " 20932							
		" " RH	1		7.47	" " 20931							
		Brakeshoe	2 pr.		2.35	" " 20932							
		Handbrake actuator LH	1		4.0	" " 20933							
		" " RH	1		4.0	" " 20934							
		Tapet	1		17	" " 20927							
		Adjuster Screw	2		05	" " 20925							
		Pull off spring, top	2		17	" " 20926							
		" " " " " " " " bottom	2		17	" " 20927							
		Wheel cyl assy	2		2.26	" " 20931							
		Casket wheel cyl	2		.08	" " 20928							
		Spring clip	2		.92	" " 20929							
		Boot (gutter)	2		5.86	" " 18148							
		Brake drum	2		.06	" " 31720							
		Screw, brake drum	2		.17	" " 314808							
		Set screw, backplate, rear axle	12		.13	" " 3170218							
		Washer, backplate, rear axle	12		1.72	Lockheed							
						RL-100706							

MARCH 31st, 1975.

ITEM NO.	EXHIBIT PART NO.	UNIT DESCRIPTION	QTY PER CAR	REMARKS	UNIT PRICE	OUR DMC. NO. OR SUPPLIERS PART NO.	ITEM NO	EXHIBIT PART NO.	UNIT DESCRIPTION	QTY PER CAR	REMARKS	UNIT PRICE	OUR DMC. NO. OR SUPPLIERS PART NO.
103001		FRONT DOOR POST L.H.	1		28.17	E8000-S-1							
103002		" " " " R.H.	1		28.17	" " 2							
103003		Rear door post L.H.	1		18.17	" " 3							
103004		" " " " R.H.	1		18.17	" " 4							
103005		Rear window pillar L.H.	1		10.12	" " 5							
103006		" " " " R.H.	1		10.12	" " 6							
103007		Roof bow forward	1		8.22	" " 7							
103008		" " centre	1		8.22	" " 8							
103009		" " rear	1		8.22	" " 9							
103010		Roof support rear	1		22.31	" " 10							
103011		Stiff L.H.	1		15.18	" " 11							
103012		" " R.H.	1		15.18	" " 12							
103013		Cant rail L.H.	1		14.83	" " 13							
103014		" " R.H.	1		14.83	" " 14							
103015		Header bar	1		21.00	" " 15							
103016		scuttle rail	1		21.27	" " 16							
103017		Side window rail L.H.	1		8.10	" " 17							
103018		" " R.H.	1		8.10	" " 18							
103019		Rear rail	1		8.10	" " 19							
103020		Infill web-rear arch L.H.	1		7.93	" " 20							
103021		" " R.H.	1		7.93	" " 21							
103022		Front side web (arch to ft.post)L.H.	1		8.05	" " 22							
103023		" " R.H.	1		8.05	" " 23							
103024		Rear side web (arch to rear post)L.H.	1		7.99	" " 24							
103025		" " R.H.	1		7.99	" " 25							
103026		Front beam	1		10.66	" " 26							
103027		Side former (ft.of ft.batt.bay) L.H.	1		6.32	" " 27							
103028		" " R.H.	1		6.32	" " 28							
103029		Side former " " " " L.H.	1		11.15	" " 29							
103030		" " R.H.	1		11.15	" " 30							
103031		Bonnet lock mounting bracket	1		22.77	" " 31							
103032		" " " " " " L.H.	1		4.56	" " 32							
103033		" " " " " " R.H.	1		4.56	" " 33							
103034		Floor extension fwd (ft. batt. bay)	1		4.42	" " 34							
103035		" " " " " " L.H.	1		4.42	" " 35							
103036		" " " " " " R.H.	1		3.90	" " 36							
103037		Rear shelf support angle	1		3.90	" " 37							
103038		" " " " " " L.H.	1		4.96	" " 38							
103039		" " " " " " R.H.	1		4.96	" " 39							
103040		Rear shelf panel	1		12.47	" " 40							
103041		Dash panel	1			" " 41							
103042		1st March, 1975.	1			" " 42							

ITEM NO	EXHIBIT PART NO.	UNIT DESCRIPTION	QTY PER CAR	REMARKS	UNIT PRICE	OUR DMC. NO. OR SUPPLIERS PART NO.
12	205201	Rear Brakes	1		9.56	Reliant 20201
12	205202	Rearbrake assy LH	1		9.56	20202
12	205203	" " RH	1		7.47	20937
1	205204	Backplate LH	1		7.47	20921
2	205205	" " RH	2		2.35	20922
3	205206	Brakeshoe	3		.40	20933
3	205207	Handbrake actuator LH	3		.40	20926
4	205208	" " RH	4		.40	20926
5	205209	Tapet	5		.17	20926
5	205210	Adjuster Screw	5		.05	20925
7	205211	Pull off spring, top	7		.17	20926
7	205212	" " " " bottom	7		.17	20927
8	205213	Wheel cvl assy	8		2.24	20931
9	205214	Gasket wheel cvl	9		.09	20928
9	205215	Spring clip	9		.17	20929
11	205216	Root (griener)	11		.82	20929
12	205217	Brake drum	12		5.86	18148
13	205218	Screw, brake drum	13		.04	20930
14	205219	Set screw, backplate, rear axle	14		.17	51720
15	205220	Washer, backplate, rear axle	15		.13	51480
		Hose assy	1		1.72	51207

MARCH 31st, 1975.

Lockheed
KL100706

ITEM NO	ENFIELD PART NO	UNIT DESCRIPTION	QTY PER CAR	REMARKS	UNIT PRICE	OUR DNG. NO. OR SUPPLIERS PART NO.	ITEM NO	ENFIELD PART NO	UNIT DESCRIPTION	QTY PER CAR	REMARKS	UNIT PRICE	OUR DNG. NO. OR SUPPLIERS PART NO.
<u>PANELS</u>													
106001		Roof	1		82.80	E8000-P-1	32	203237					
106002		Roof lid panel	1		14.72	" " 2	33	203238	Rearing, pinion tail	1		1.04	Rialane 6411
106003		Roof quarter (diag) RH	1		54.62	" " 3	34	203239	Collapsible spacer	1		.97	" "
106004		" " RH	1		54.62	" " 4	35	203240	Spacer, pinion head	as req.		.17	" "
106005		Door panel LH	1		14.95	" " 5	36	203241	Oil seal, pinion	1		.63	" "
106006		" " RH	1		14.95	" " 6	37	203242	Coupling flange	1		1.73	" "
106008		Front wing LH	1		37.37	" " 7	38	203243	Washer, coupling flange	1		.11	" "
106009		" " RH	1		37.37	" " 8	39	203244	Nut, coupling flange	1		.28	" "
106010		Scuttle	1		27.02	" " 9	40	203245	Clip, bundy to axle	2		.11	" "
106011		Roof lid panel	1		14.40	" " 10	41	203246	Bracket, handbrake support	1		.80	" "
106012		Roof valance	1		14.72	" " 11	42	203247	Bracket, handbrake cable support	2		.23	" "
106013		Roof rail cap	1		6.61	" " 12	43	203248	Sideplate, diagonal link	1		.32	" "
106014		Roof valance	1		14.08	" " 13	44	203249	Bolt, bracket, handbrake cable	4		.11	" "
106015		Roof pillar cap LH	1		6.32	" " 14	45	203250	Lockwasher	4		.65	" "
106016		Roof pillar cap RH	1		6.32	" " 15			Differential Assy	1		96.60	" "
106017		Gutter cap LH	1		6.21	" " 16							
106018		" " RH	1		6.21	" " 17							
106019		Roof bumper	1		29.01	" " 18							
106020		Roof bumper	1		28.46	" " 19							
106021		Door lid complete	1		28.17	" " 20							
106022		Door lid complete LH	1		46.57	" " 21							
106023		" " RH	1		46.57	" " 22							
106024		Roof complete LH	1		34.50	" " 23							
106025		" " RH	1		34.50	" " 24							
106026		Roof complete	1			" " 25							
106027		" " LH	1			" " 26							
106028		" " RH	1			" " 27							
106029		Roof complete	1			" " 28							
106030		" " LH	1			" " 29							
106031		" " RH	1			" " 30							
106032		Roof bumper	1			" " 31							
106033		Door lid complete	1			" " 32							
106034		Door lid complete LH	1			" " 33							
106035		" " RH	1			" " 34							
106036		Roof complete	1			" " 35							
106037		" " LH	1			" " 36							
106038		" " RH	1			" " 37							
106039		Roof complete	1			" " 38							
106040		" " LH	1			" " 39							
106041		" " RH	1			" " 40							
106042		Roof complete	1			" " 41							
106043		" " LH	1			" " 42							
106044		" " RH	1			" " 43							
106045		Roof complete	1			" " 44							
106046		" " LH	1			" " 45							
106047		" " RH	1			" " 46							
106048		Roof complete	1			" " 47							
106049		" " LH	1			" " 48							
106050		" " RH	1			" " 49							
106051		Roof complete	1			" " 50							
106052		" " LH	1			" " 51							
106053		" " RH	1			" " 52							
106054		Roof complete	1			" " 53							
106055		" " LH	1			" " 54							
106056		" " RH	1			" " 55							
106057		Roof complete	1			" " 56							
106058		" " LH	1			" " 57							
106059		" " RH	1			" " 58							
106060		Roof complete	1			" " 59							
106061		" " LH	1			" " 60							
106062		" " RH	1			" " 61							
106063		Roof complete	1			" " 62							
106064		" " LH	1			" " 63							
106065		" " RH	1			" " 64							
106066		Roof complete	1			" " 65							
106067		" " LH	1			" " 66							
106068		" " RH	1			" " 67							
106069		Roof complete	1			" " 68							
106070		" " LH	1			" " 69							
106071		" " RH	1			" " 70							
106072		Roof complete	1			" " 71							
106073		" " LH	1			" " 72							
106074		" " RH	1			" " 73							
106075		Roof complete	1			" " 74							
106076		" " LH	1			" " 75							
106077		" " RH	1			" " 76							
106078		Roof complete	1			" " 77							
106079		" " LH	1			" " 78							
106080		" " RH	1			" " 79							
106081		Roof complete	1			" " 80							
106082		" " LH	1			" " 81							
106083		" " RH	1			" " 82							
106084		Roof complete	1			" " 83							
106085		" " LH	1			" " 84							
106086		" " RH	1			" " 85							
106087		Roof complete	1			" " 86							
106088		" " LH	1			" " 87							
106089		" " RH	1			" " 88							
106090		Roof complete	1			" " 89							
106091		" " LH	1			" " 90							
106092		" " RH	1			" " 91							
106093		Roof complete	1			" " 92							
106094		" " LH	1			" " 93							
106095		" " RH	1			" " 94							
106096		Roof complete	1			" " 95							
106097		" " LH	1			" " 96							
106098		" " RH	1			" " 97							
106099		Roof complete	1			" " 98							
106100		" " LH	1			" " 99							
106101		" " RH	1			" " 100							

March 31st, 1975.

MARCH 31st, 1975.

PANELS

REAR AXLE cont'd

ITEM NO	ENFIELD PART NO	UNIT DESCRIPTION	QTY PER CAR	REMARK	UNIT PRICE	OUR DRG. NO. OR SUPPLIERS PART NO.
<u>REAR AXLE</u>						
K2	203201	Bump stop	2		1.49	Ford 118E 3020
1	203202	Rear axle	1	Less bump stops & stiffening	106.72	
2	203203	Axle case	1		18.86	Reliant 20337
3	203204	Breather	1		.46	" 20476
4	203205	Filler plug	1		.60	" 1294
5	203206	Stud axle case fixing	8		.05	" 20485
6	203207	Cover plate axle case	1		10.52	" 20489
7	203208	Nut, cover plate to axle case	8		.04	" 506828
8	203209	Washer "	8		.04	" 512026
9	203210	Axle tube Assy, LH	1		22.05	" 20538
10	203211	" " RH	1		22.42	" 20539
11	203212	" half shaft	2		14.08	" 20186
12	203213	Collar, axle shaft	2		1.66	" 6490
13	203214	Oil seal, axle end	2		3.85	" 6733
14	203215	Ball bearing, axle end	2		10.63	" 20435
15	203216	Hub Assy	2		10.40	" 20189
16	203217	Stud, rear hub	8		.17	" 20190
17	203218	Key, hub securing	2		.09	" 20191
18	203219	Washer, hub retaining	2		.06	" 5612
19	203220	Nut, hub retaining	2		.28	" 4880
20	203221	Pinion	1	3.55 ratio	281.29	" 506488
21	203222	Crown wheel	1	3.55 ratio	37.37	" 20194
22	203223	Rivet crown wheel	8		.09	" 5888
23	203224	Differential case	1		20.58	" 2759
24	203225	Wheel differential	2		5.06	" 20458
25	203226	Thrust washer, wheel	2		.51	" 5973
26	203227	Pinion, differential	2		2.64	" 2611
27	203228	Thrust washer, pinion	2		1.28	" 1940
28	203229	Pin, differential	1		1.52	" 1943
29	203230	Lock pin, diff pin	1		4.83	" 7056
30	203231	Taper bearing, differential	2	as req.	.51	" 7021
31	203232	Shim, diff bearing	1		.21	" 20195
		" "			.51	" 2282
		" "			.28	" 2284
		" "			4.77	" 200209

MARCH 31st, 1975.

ITEM NO	ENFIELD PART NO	UNIT DESCRIPTION	QTY PER CAR	REMARK	UNIT PRICE	OUR DRG. NO. OR SUPPLIERS PART NO.
<u>GLASS</u>						
	105021	Windscreen	1		104.65	E8000-P-21
	105022	Rear screen	1		23.00	" " 22
	105023	Front sliding glass (door)	2		8.05	" " 23
	105024	Rear sliding glass (door)	2		10.35	" " 24
	105025	Side window LH	1		10.35	" " 25
	105026	" " RH	1		10.35	" " 26
	105121	Windscreen seal and insert	1		2.99	Waterford
	105122	Rear screen seal and insert	1		2.30	"
	105123	Side window seal and insert	1		1.55	"
	105125	Sliding window channel	2		1.68	Fowlers BMC Mini

ITEM NO	ENFIELD PART NO	EMIT DESCRIPTION	QTY PER CAR	REMARKS	UNIT PRICE	OUR DRG. NO. OR SUPPLIERS PART NO.
		<u>TRIM</u>				
106001		Seats	2		25.87	Enfield
106002		Seat	2		2.87	Rostall
106003		Runners, seat	1		7.13	Enfield
106004		Trim panel, door LH	1		3.04	
106005		" " RH	1		3.04	
106006		Capping, door trim LH	1		10.12	
106007		" " RH	1		7.59	
106008		Rear seat squab	1		4.08	
106009		Rear seat back	1		4.08	
106010		Side trim panel L.R.	1		2.58	
106011		" " RH	1		2.58	
106012		Capping side trim LH	1		6.09	
106013		" " RH	1		6.09	
106014		Carpet, front LH	1			
		Carpet, front RH	1			
		MARCOH 31st, 1975.				

ITEM NO	ENFIELD PART NO	UNIT DESCRIPTION	QTY PER CAR	REMARKS	UNIT PRICE	OUR DRG. NO. OR SUPPLIERS PART NO.
		<u>SUSPENSION</u>				
202015		Diagonal link (rear suspension)	1		7.66	ER800-C-15
202019		Wishbone Assy LH	1		25.87	" " 19
202020		" " RH	1		25.87	" " 20
202022		Front sub frame (wishbone tray)	1		16.10	" " 22
202002		Hub front wheel	2		10.92	" M-2
202201		Bush (diagonal link)	4		.23	Dunlop 13/0930
202202		Bush (trailing link)	8		.40	13/1667
202203		Bush (wishbone)	4		5.80	13/1436
202204		Road wheel	2		1.09	LP 918 (Mint)
202205		Hub cap	2		5.34	Eversure WY 5174
202206		Shock absorber	2		6.37	Armstrong
202207		Koad spring	4		5.80	Park spring (240 lb)
202208		Carrier (stub axle) LH	1		1.89	Chrysler 7050129
202209		" " RH	1		17.88	" 7050128
202210		Swivel pin kit	2		17.88	" 7050170
202211		Stub axle LH	1		17.88	" 7050195
202212		" " RH	1		.28	" 7050194
202213		Bolt hub	8		1.03	" 88C-172
202214		Nut hub	8		3.45	Gaco NIS 16
202215		Seal hub	2		3.45	SKF-146610-146649
202216		Inner wheel bearing	2		2.3	SKF-LM-11910-119109
202218		Outer wheel bearing	2		2.3	Chrysler 7102100
202220		Washer (bearing retaining)	2		.28	" 71021274
202221		Nut (bearing)	4		.06	" 7102102
202222		Washer (lock)	4		.13	" 7102101
202223		Driver (speed)	1		.51	" 115138
202224		Plate retaining (speedo drive)	1		.05	" 3931061
202225		Washer rubber (speedo drive seal)	1		2.35	ER800-N-121
202226		Cap grease LH hub	2		7.64	FRCO-C-16
202227		" " RH	2		7.64	" C-17
202228		Collar - stub - axle	1		11.50	Avon W
202229		Trailing link upper (rear suspension)	2			
202015		" " lower	2			
202017		" " steel belted 145 SR10	5			
202201		" " tyre, radial, steel belted 145 SR10	5			
		MARCOH 31st 1975.				

POST IN 1975

for part no. 202224